



FSF map at Transpolis Organisation and security

Formula Student France 2025
Last update : 22/08/2025

Classification level: **confidential**

[See the official video](#)

 **Transpolis**

Legend

 Gate / barrier to restrict access
(in the city = regulated by dynamic area marshals)

 Control – Security Officer

 Parking

 Vauban-style barrier

 Worxsafe-type barrier – crossing prohibited

 Tape-style marking for delimitation

 No entry for the public

 Pedestrian zone

 Restricted area,
Staff and paddock only

 Closed area

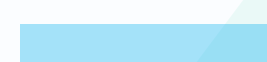
 Camping area, reserved for
students with a camping pass

Barriers

Vauban

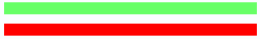

Héras



Worxsafe

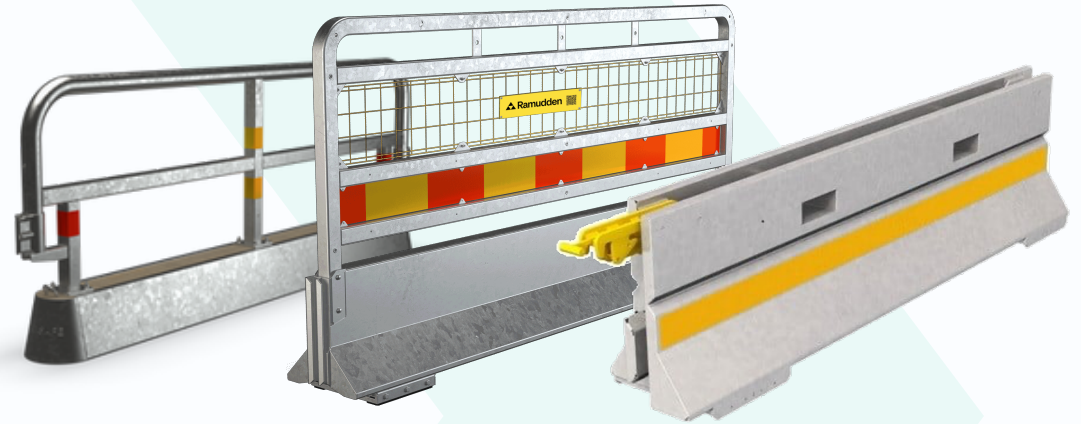

Tape-style

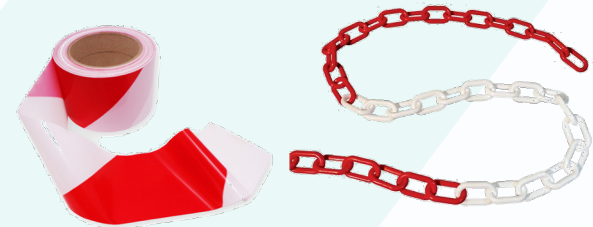
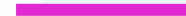

Arrival and parking management

Students, sponsors, and partners enter the site directly to park in the city. Access will be controlled at the gate.
For the public, from Friday to Sunday, parking will be on P1 and P2.



Parking
Site arrival



Venue entry details



Site access route

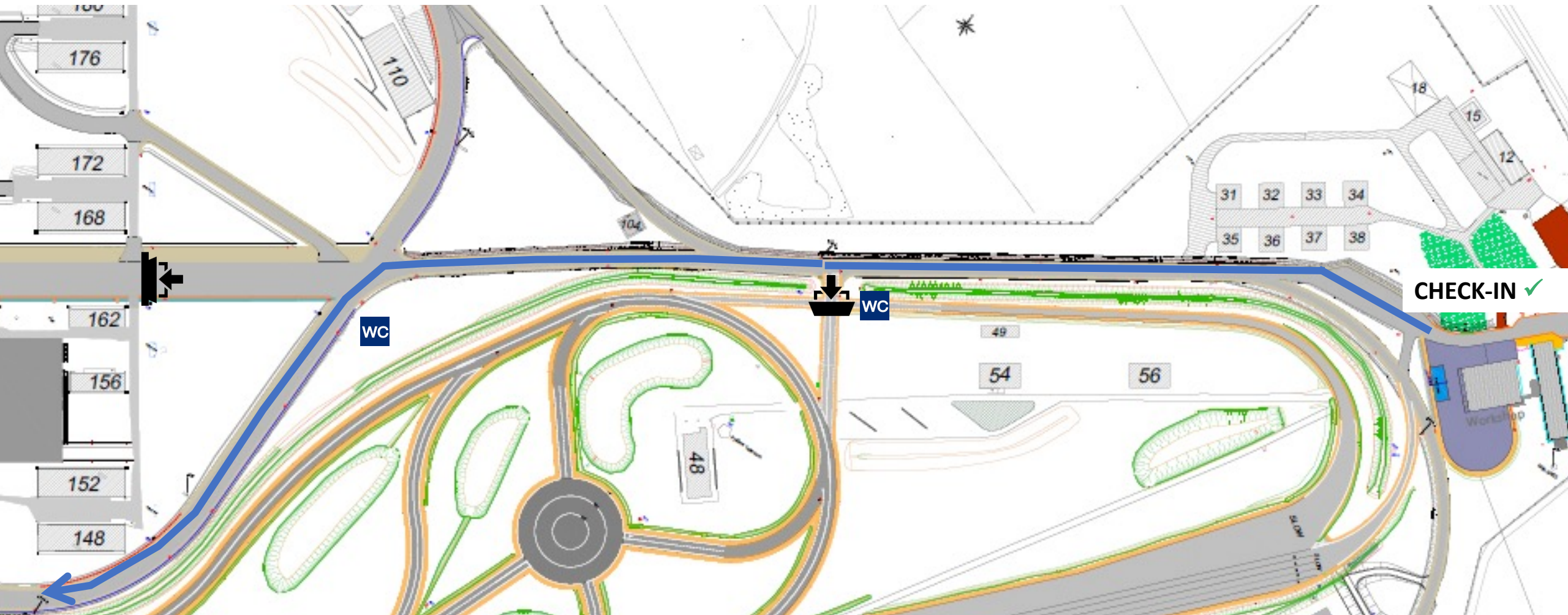

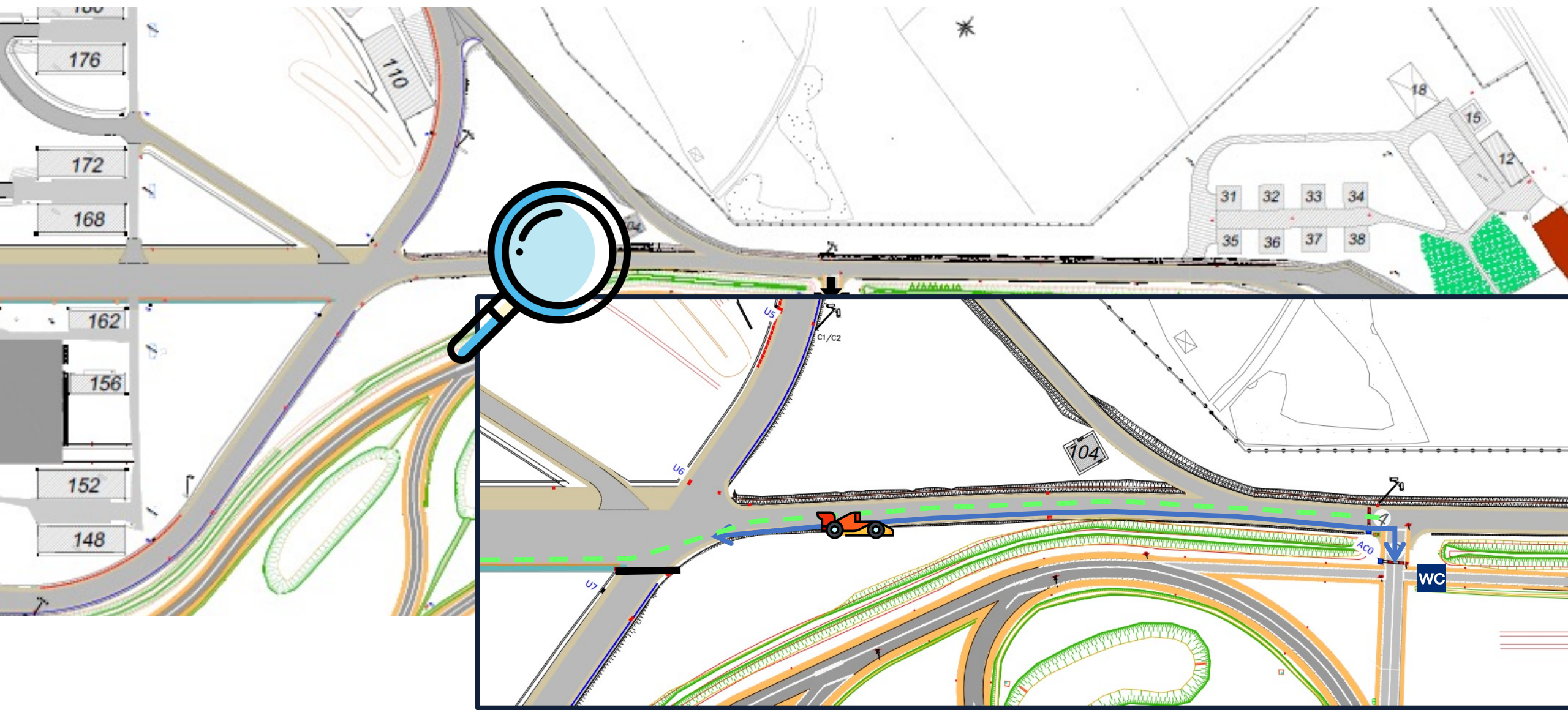

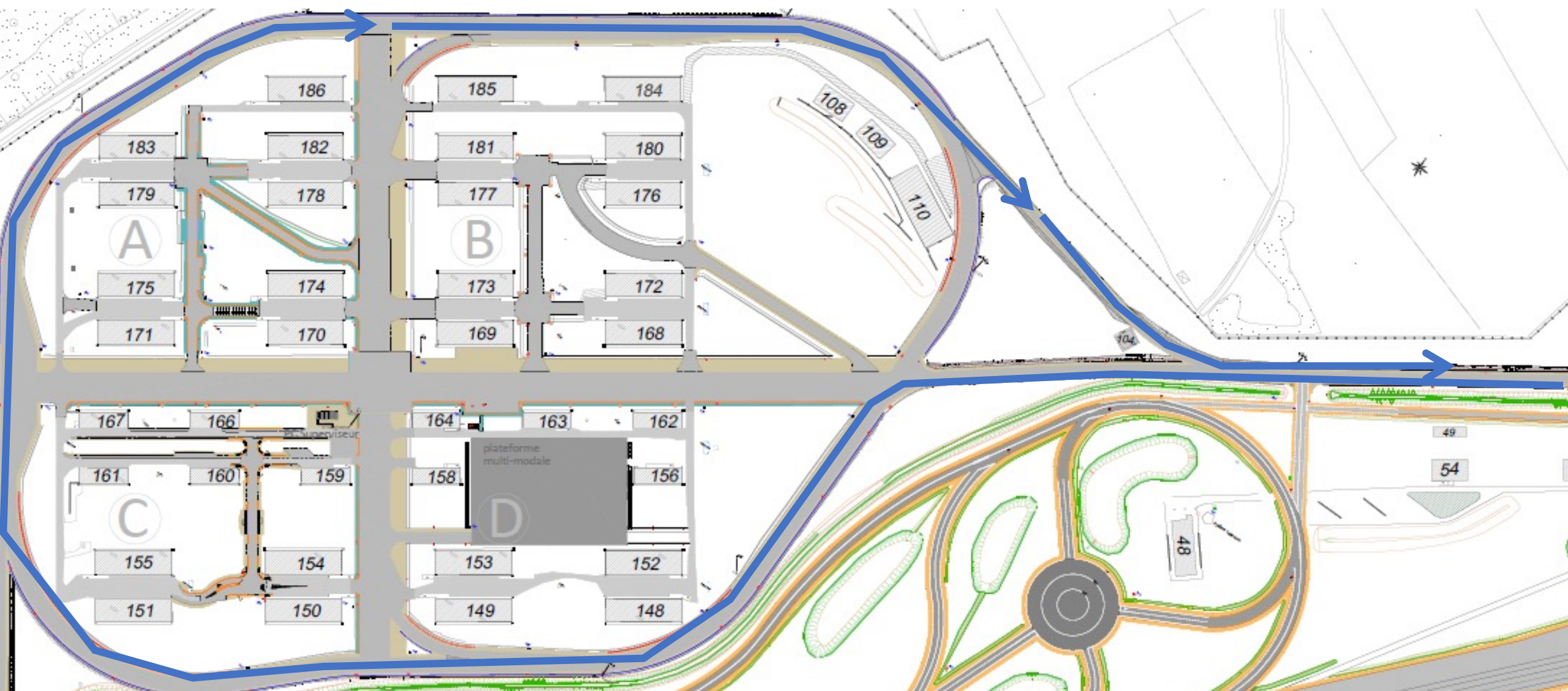

Global map FSF25

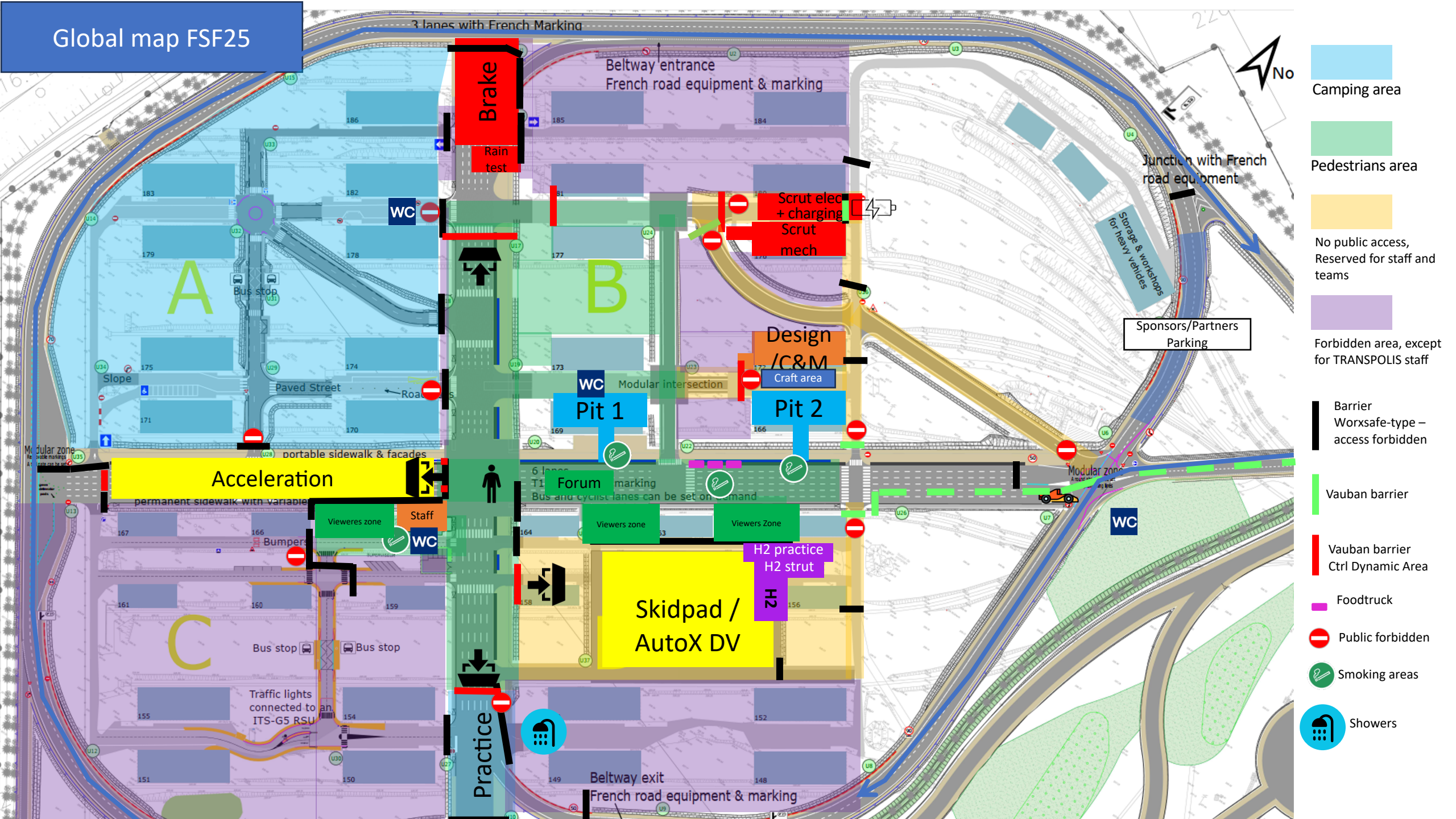

Pit 1 - 168

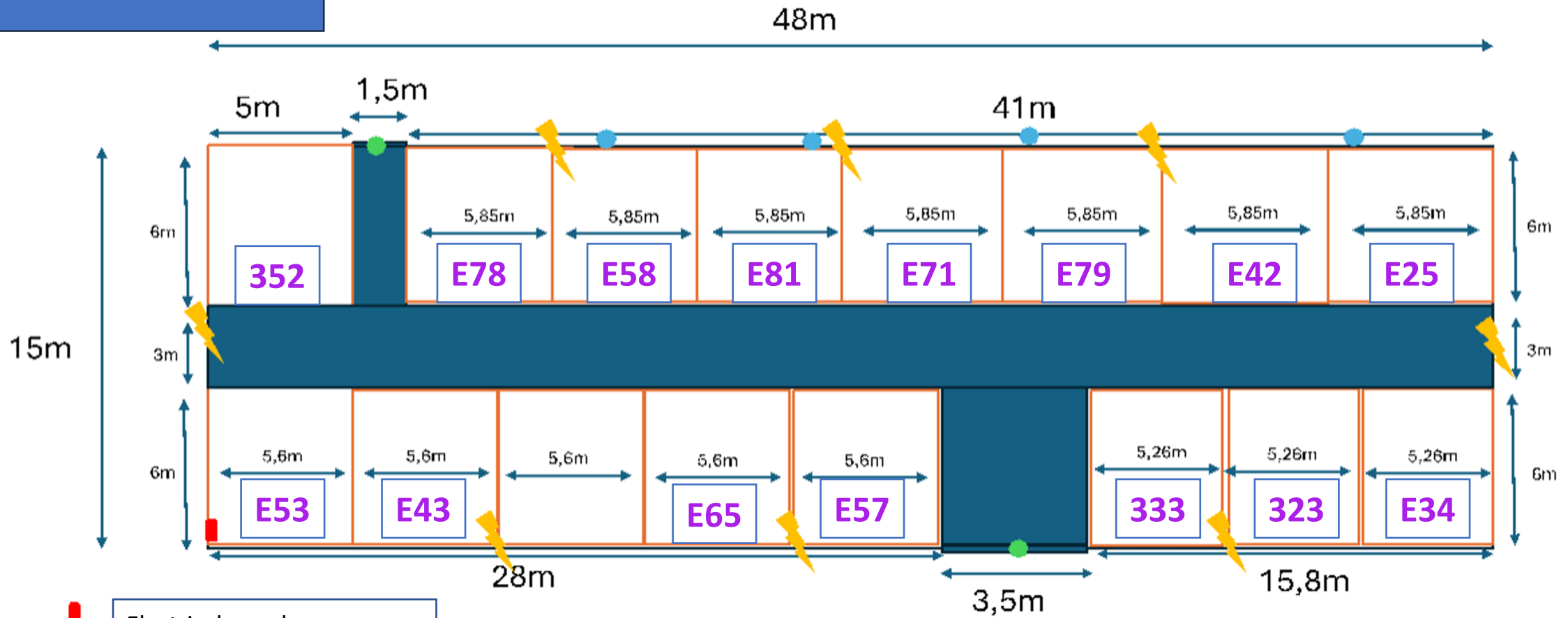

Pit 2 - 169

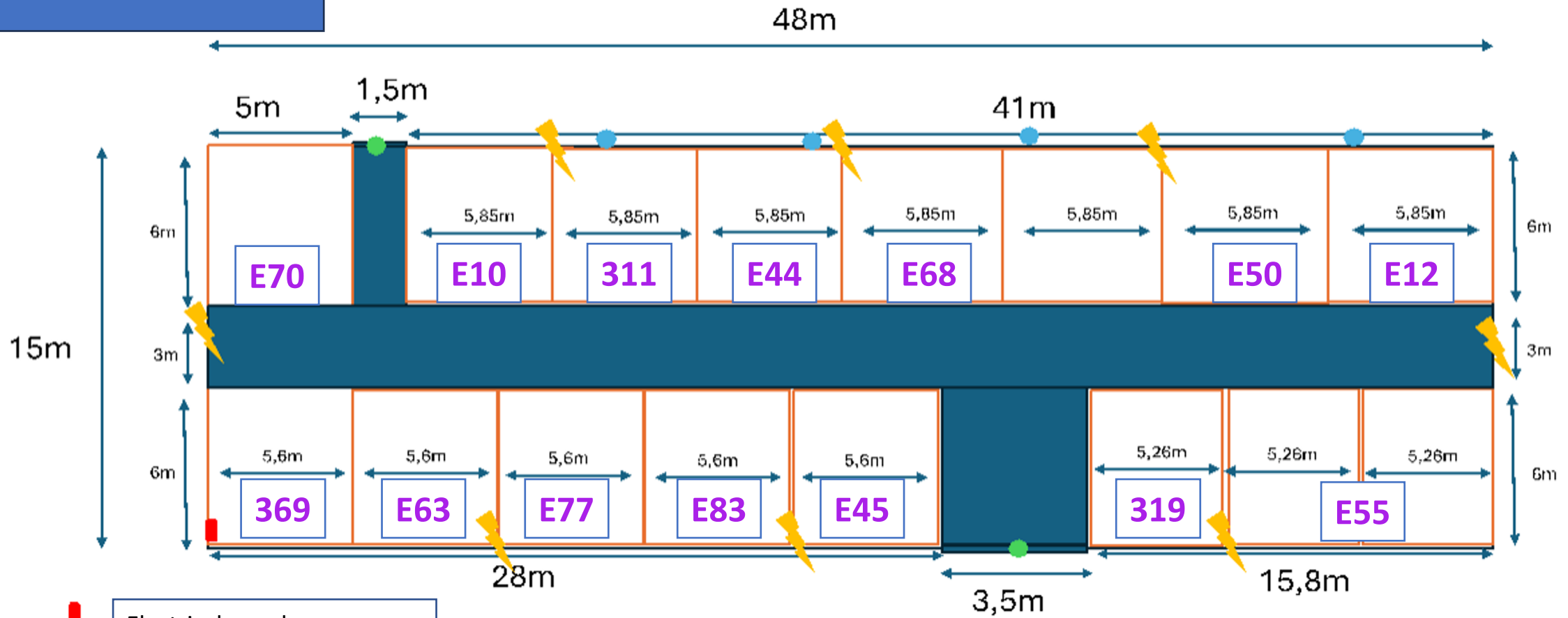

Campsite map



Camping parking

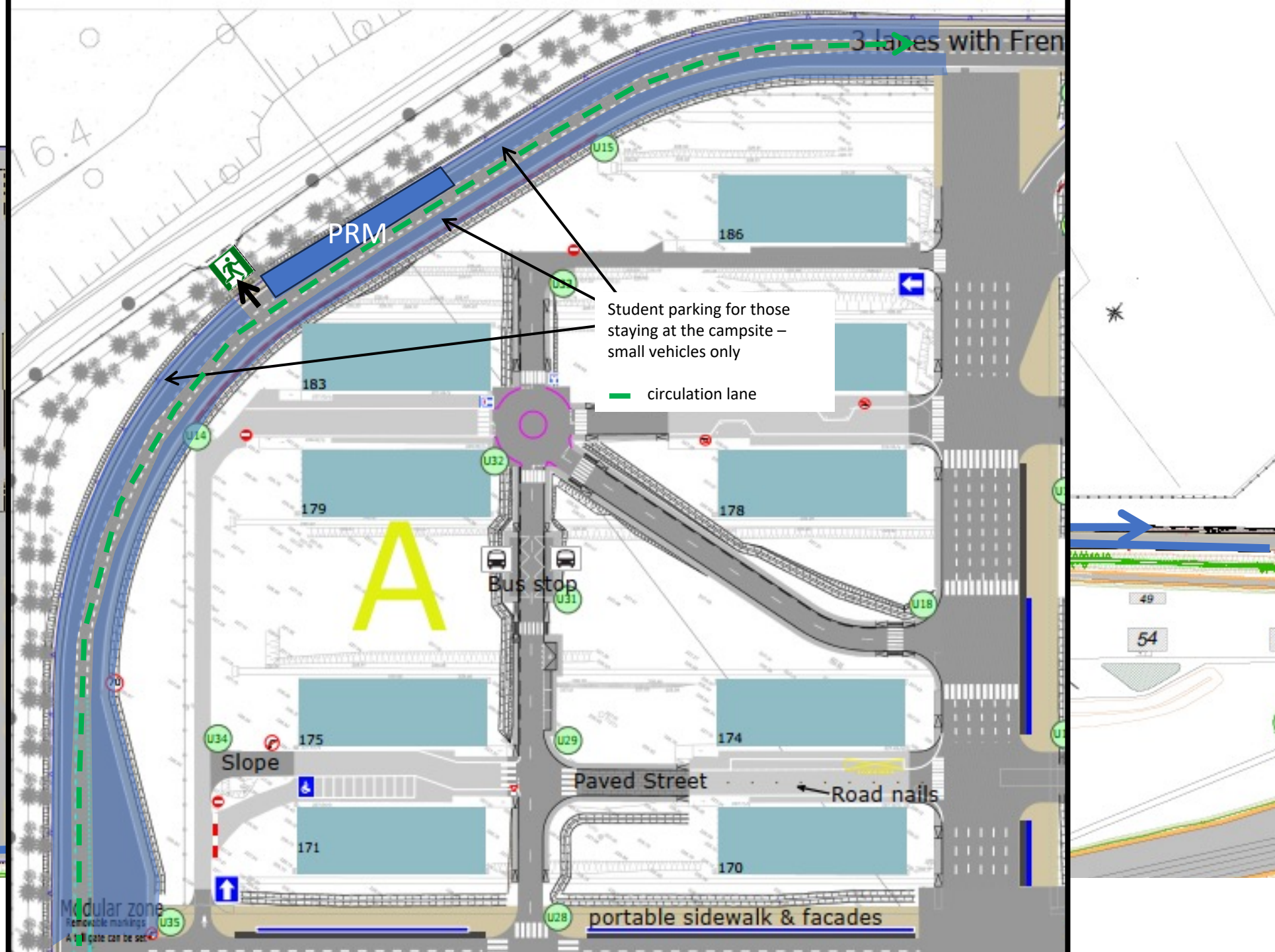
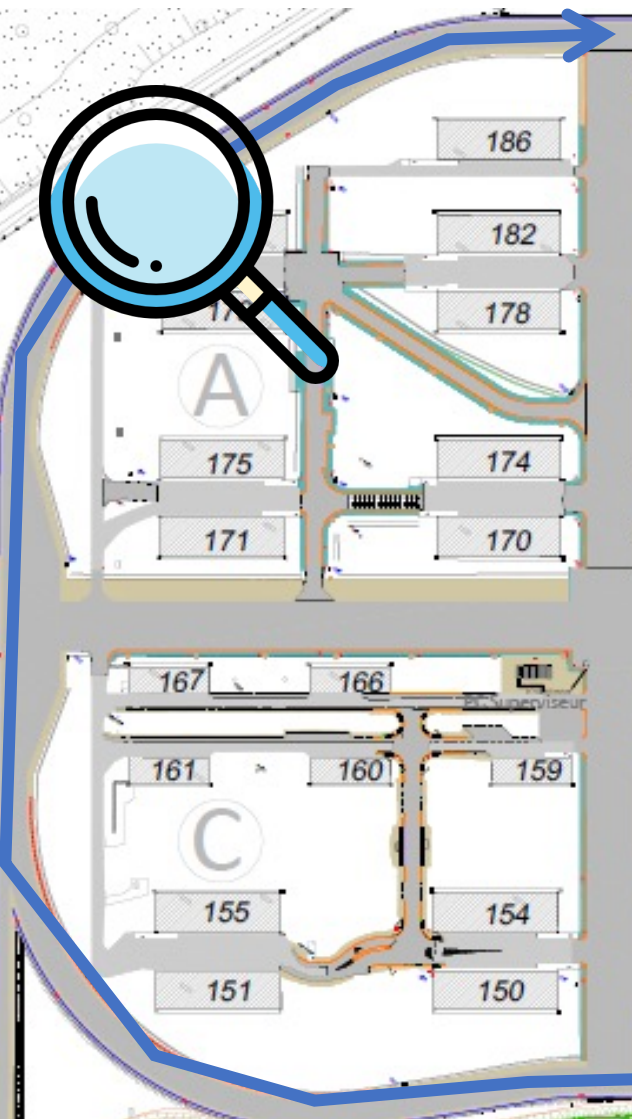

Water

3 lanes with French Marking

Beltway entrance
French road equipment & marking

Junction with French
road equipment

Rain

- Water dispenser
- Sink

Skidpad
wet

Beltway exit
French road equipment & marking

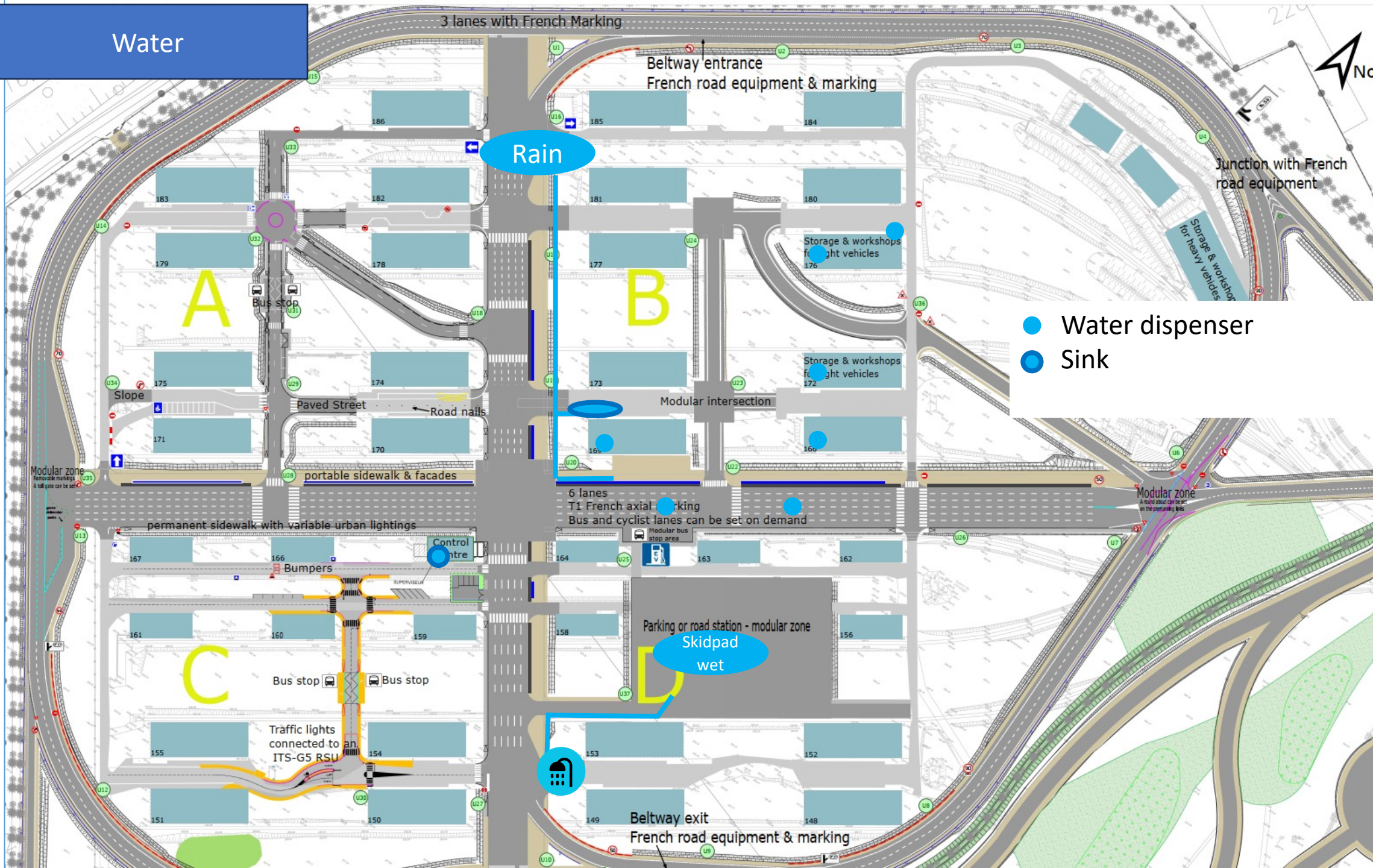

Glass bins – out of the
venue

234 route de Saint Maurice
Martinaz
01500 Saint Maurice de Rémens

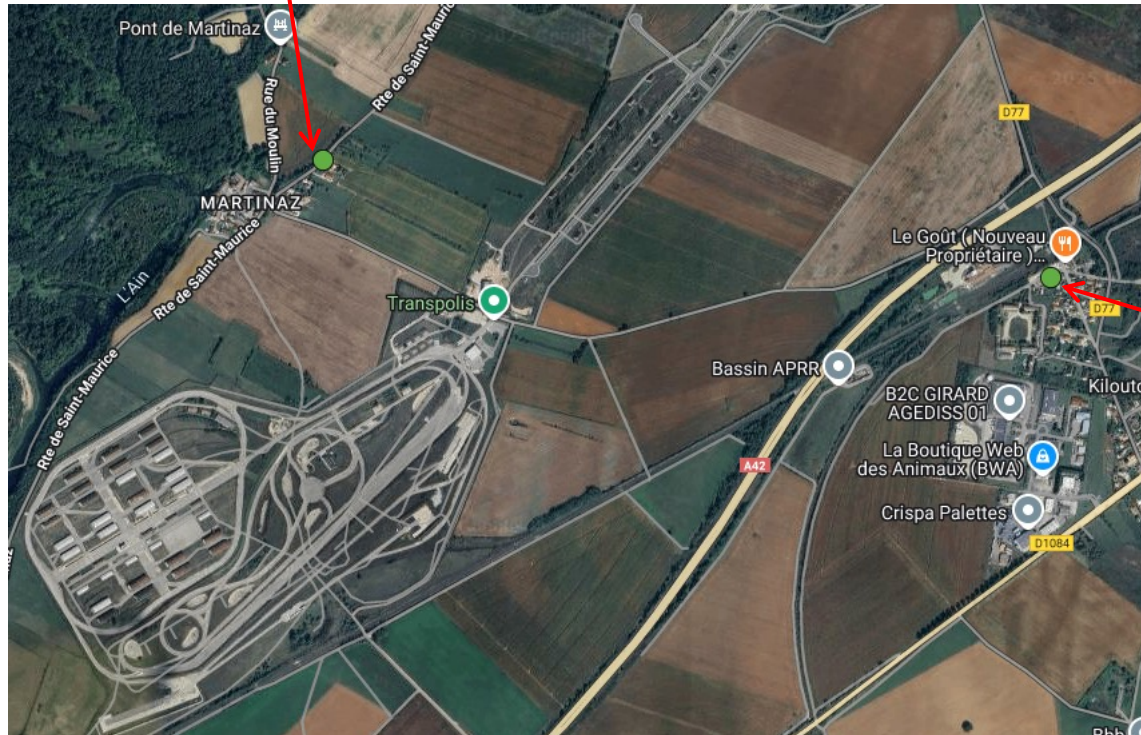

1587 Rue de la Gare
01150 Leyment

AutoX/Endurance
viewers zone



Access / Stairs

Viewers zone

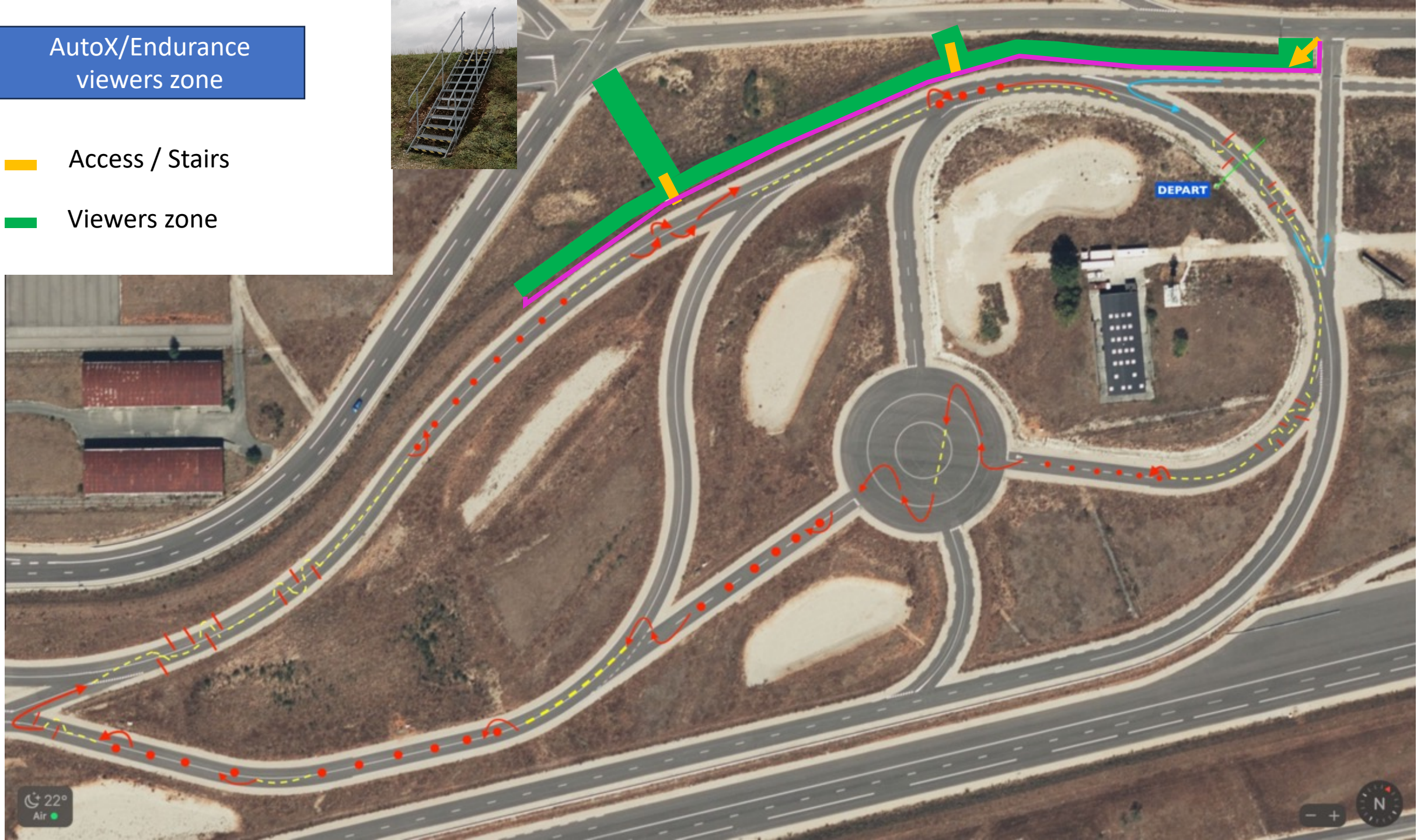

Venue

- Event village
- Campsite
- Volunteers catering & BP rooms

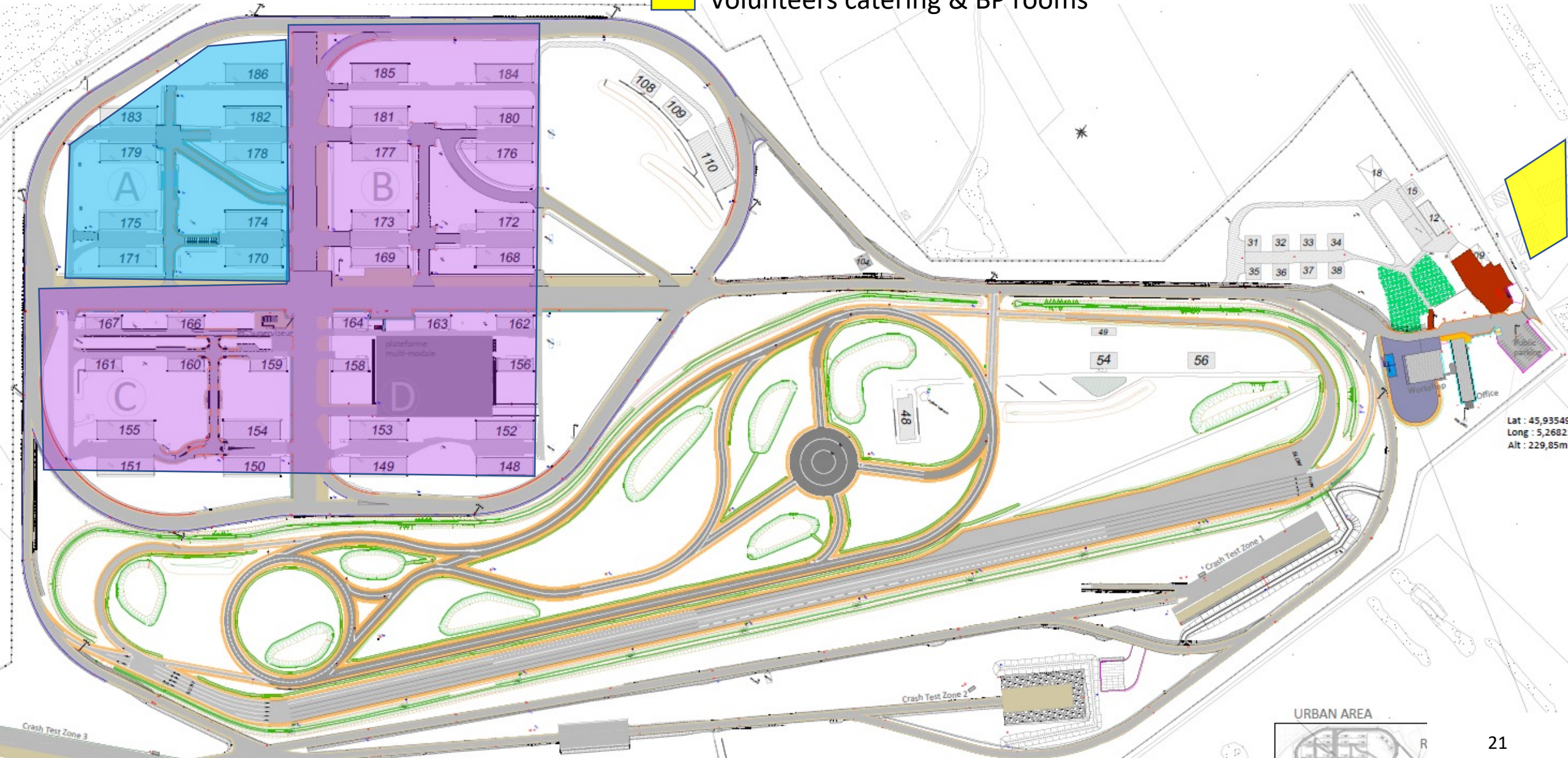

Dynamic areas



Emergency assembly point



Fire water reserves

